

CARVEWRIGHT

W O O D W O R K I N G S Y S T E M

Replacing the Left Lateral Side Panel/Control Panel/Stabilizer

To remove and replace the side panel you will need the following tools:

- #2 Phillips screwdriver (magnetic tip preferred)
- Socket wrench with 10mm socket

Removing the Side Panel

1. **Ready the machine.** Unplug it from the power outlet and place it on a stable work platform. Crank the head up to within 1" of the top for best access.
2. **Remove the cable protector for the cables routed from the base to the movable head along the inside of the left side panel assembly.** Remove the single screw as shown in Figure 4 with a #2 Phillips screwdriver. Use a magnetic tipped screwdriver if possible to avoid dropping the screws into the machine. Remove plastic cable protector from the machine.

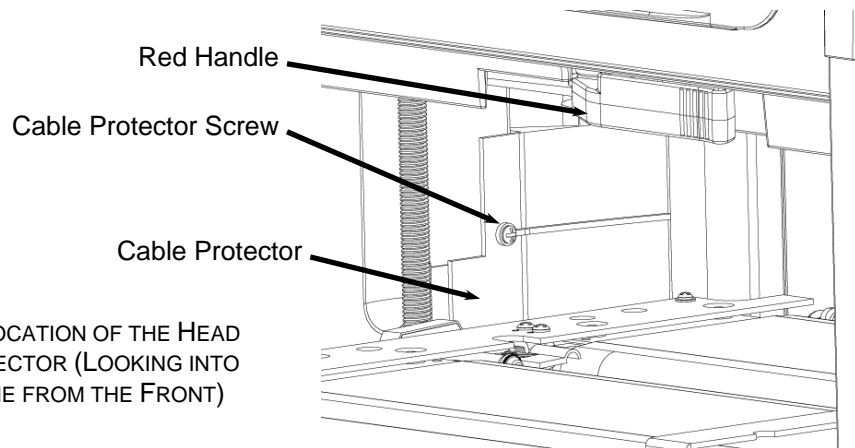

FIGURE 1: LOCATION OF THE HEAD CABLE PROTECTOR (LOOKING INTO THE MACHINE FROM THE FRONT)

3. **Unplug the LCD cable.** Grasp and pull the LCD cable connector straight out. Lay the cable end to the side of the panel.

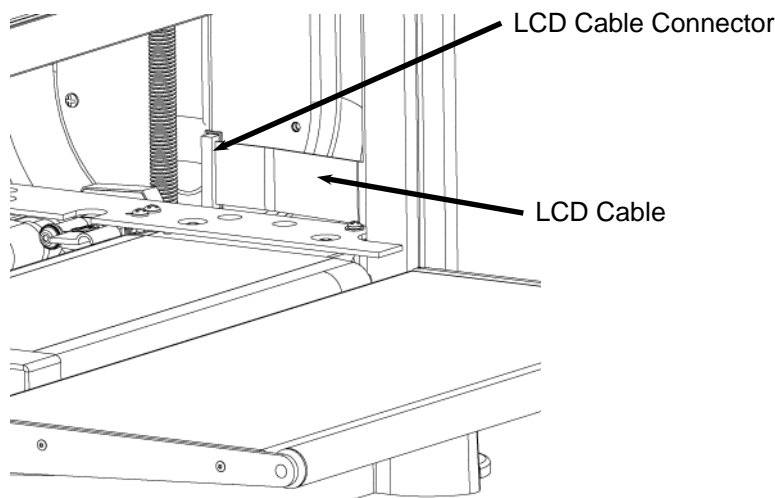

FIGURE 2: LOCATION OF THE LCD CABLE (LOOKING INTO THE MACHINE FROM THE BACK)

4. **Remove the left side panel assembly.** Using the 10mm socket remove the two hex head bolts (and washers) from the top of the assembly. Remove the two Phillips head screws from the base of the side panel with the screwdriver. Lift off the side panel.

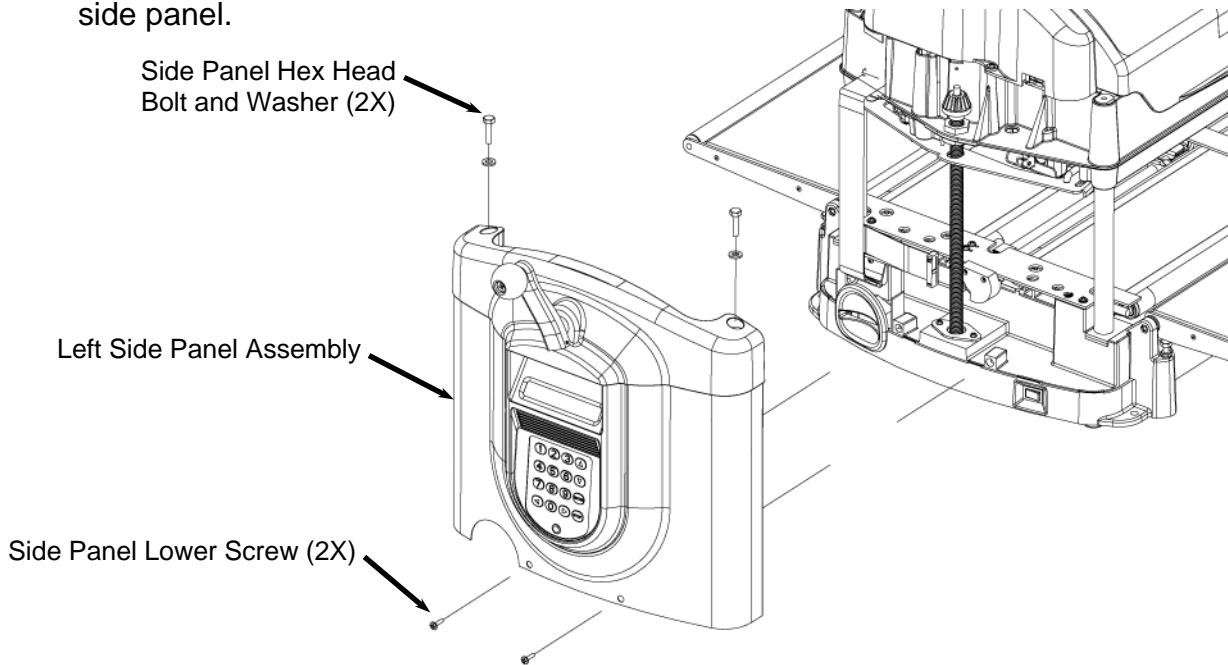

FIGURE 3: EXPLODED VIEW OF THE LEFT SIDE PANEL FASTENERS

5. **Clean the machine.** Make sure to remove all dust behind and around the base of the panel. This will assure a smooth reassembly, and that no dust will get into the open connectors.

If you are removing the Control Panel, proceed with Step 6. If you are replacing the Left Lateral Stabilizer, Skip Step 6 and start with Step 7.

6. **Remove the control panel.** Remove the two Phillips head screws that hold the top of the control panel to the lateral stabilizer handle with the screwdriver. These screws are oriented vertically and are hard to see as they are under the handle. Remove the three screws from the back side of the metal side panel that secure the control panel to the side panel. Lift off the control panel.

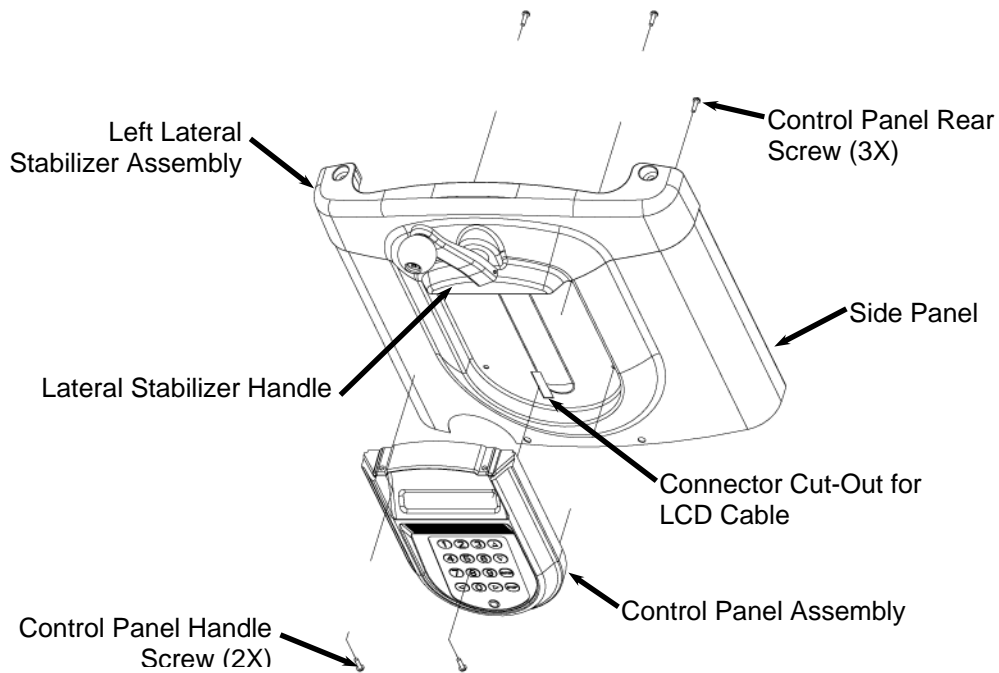

FIGURE 4: REMOVING THE CONTROL PANEL ASSEMBLY

- 7. Remove the left lateral stabilizer assembly.** Remove the two Phillips head screws that hold the top of the control panel to the lateral stabilizer handle with the screwdriver (see Figure 5). These screws are oriented vertically and are hard to see as they are under the handle. Remove the two screws from the back side of the metal side panel that secure the lateral stabilizer to the side panel. Lift off the lateral stabilizer.

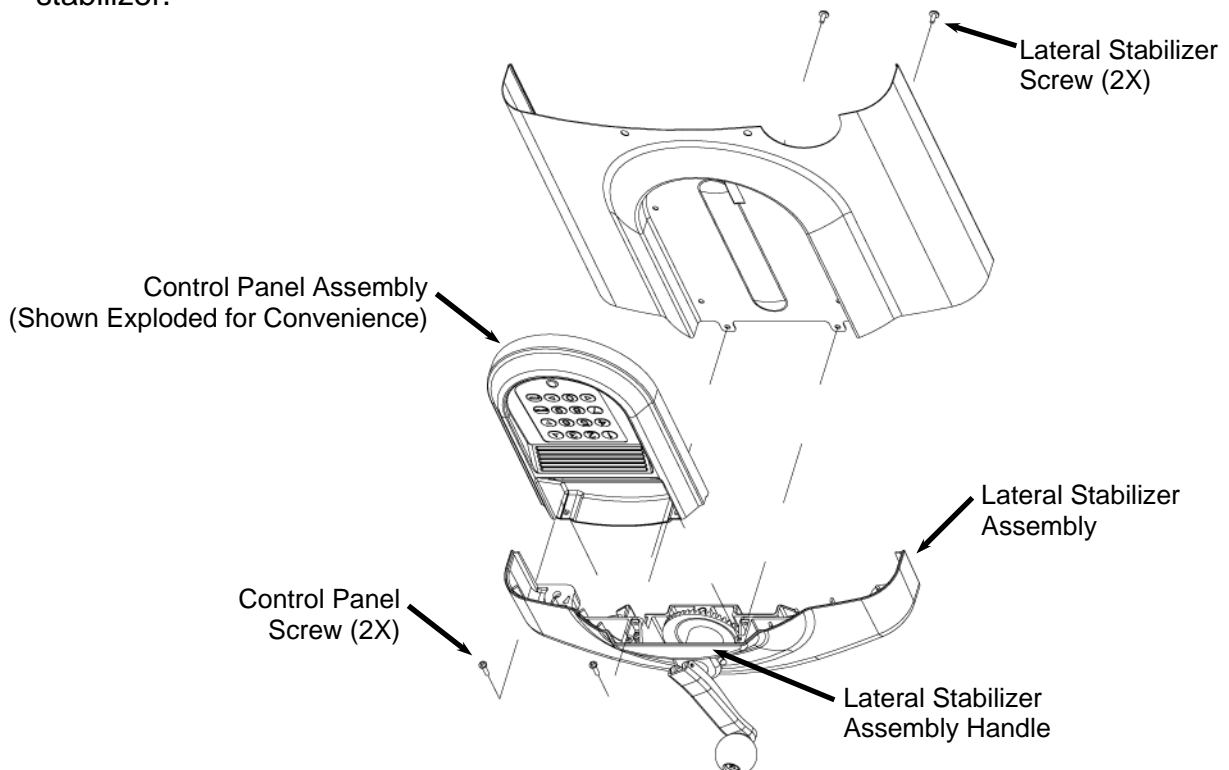

FIGURE 5: REMOVING THE LEFT LATERAL STABILIZER ASSEMBLY

Reassembling the Side Panel

1. **Replace the broken part.** Depending on which part you are replacing, use the above disassembly instruction as a guide to replace the broken part.
2. **Replace the right side panel assembly.** Place the side panel assembly back onto the machine making sure that the bottom of the panel sits into the grooves and tabs located on the base casting. Insert the two bottom screws and tighten with a #2 Phillips screwdriver. Insert the top hex head bolts (with washers) and tighten with the 10mm socket.
3. **Plug in the LCD ribbon cable.** Plug the LCD ribbon cable into its connector located in a cutout on the back of the side panel assembly (see Figure 7).
4. **Re-assemble the cable protector.** While holding the three ribbon cables up against the side panel, slide the plastic cable protector into position over the screw hole in the side panel. Insert and tighten the screw. Verify that the cables are well secured behind the cable protector and that none are bent or pinched.