

Removing and Replacing the Power Supply

In order to replace the power supply electronics board you will need the following tools:

- #2 Phillips screwdriver or power drill with #2 screw bit

Removing the Power Supply Electronics Board

The power supply electronics board (power supply) supplies the AC and DC power used by the different machine components. In the event that the power supply needs to be replaced, please follow the procedures described in this document.

1. **Ready the machine.** Unplug the machine from the power outlet and place it on a stable work platform. Remove the dust collection bag from the back of the machine.
2. **Remove the bottom cover.** Carefully lay the machine on its back with the dust collection port facing down. Remove the 12 screws securing the black sheet metal cover onto the base (four of which are located in the rubber feet) and remove it.

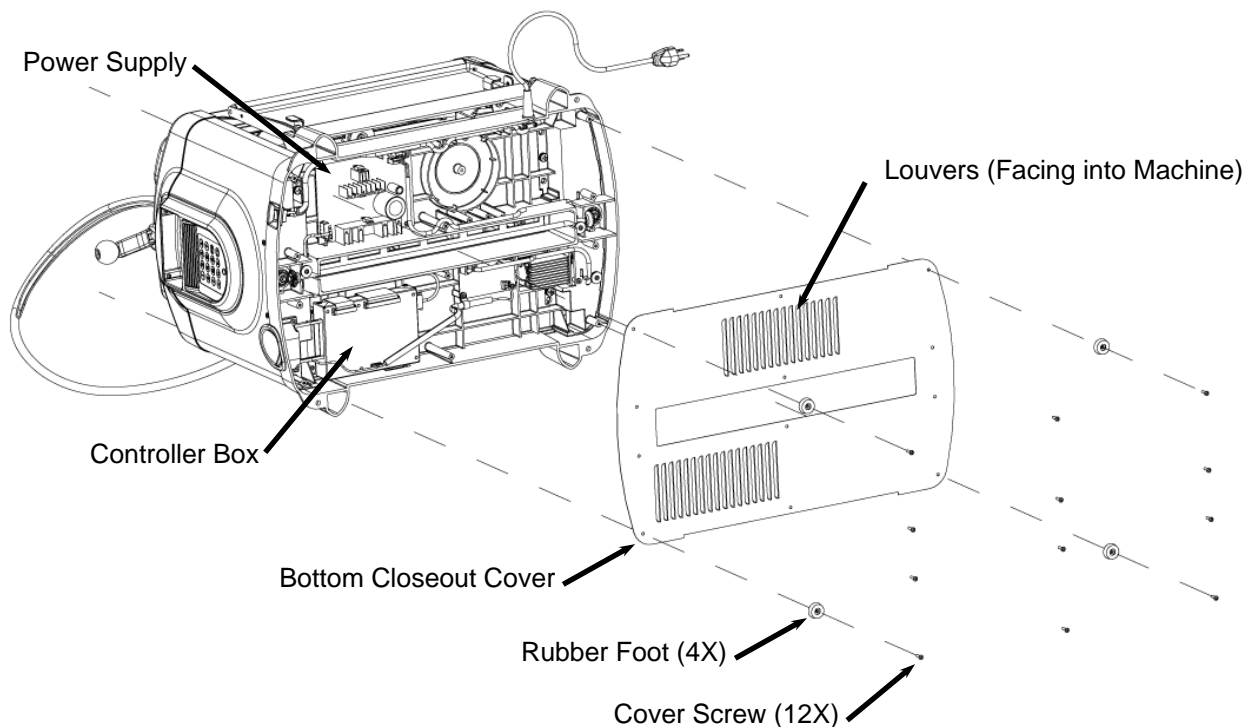

FIGURE 1: REMOVAL OF THE BOTTOM COVER

3. **Unplug the three cables connected to the power supply.** Locate the power supply board and unplug the DC power cable, the incoming AC power cable (coming from the AC wall plug) and the outgoing AC power cable. Please note that while the locations of the connectors in the picture below are correct, the appearance of the real power supply board may differ from the representation in this picture.

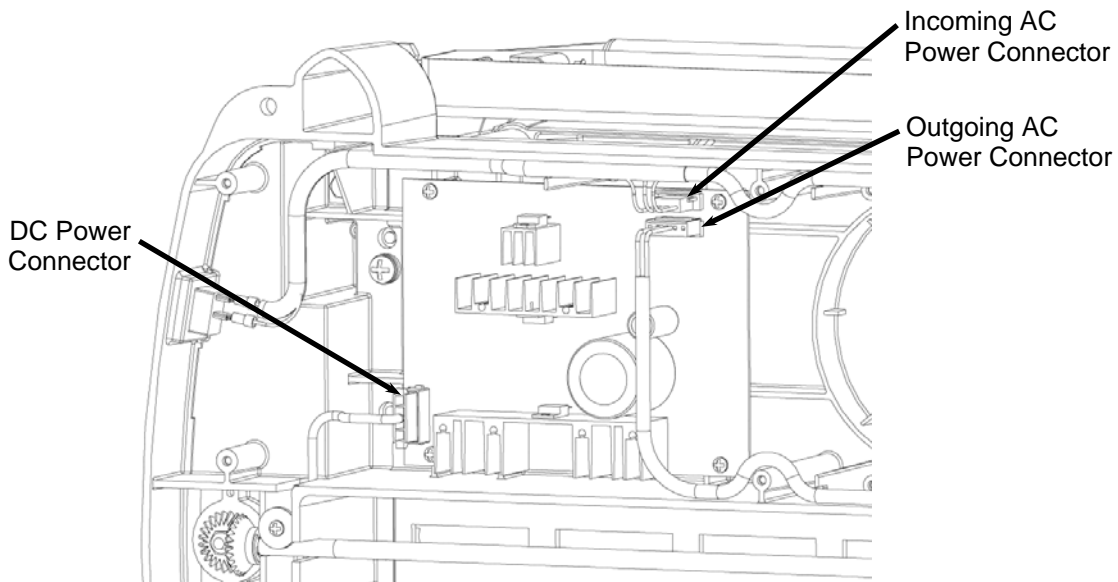

FIGURE 2: LOCATION OF THE POWER SUPPLY CONNECTORS

4. **Remove the power supply.** Use the #2 Philips head screw-driver to remove the four screws that attach the power supply to the base casting and lift the supply free.

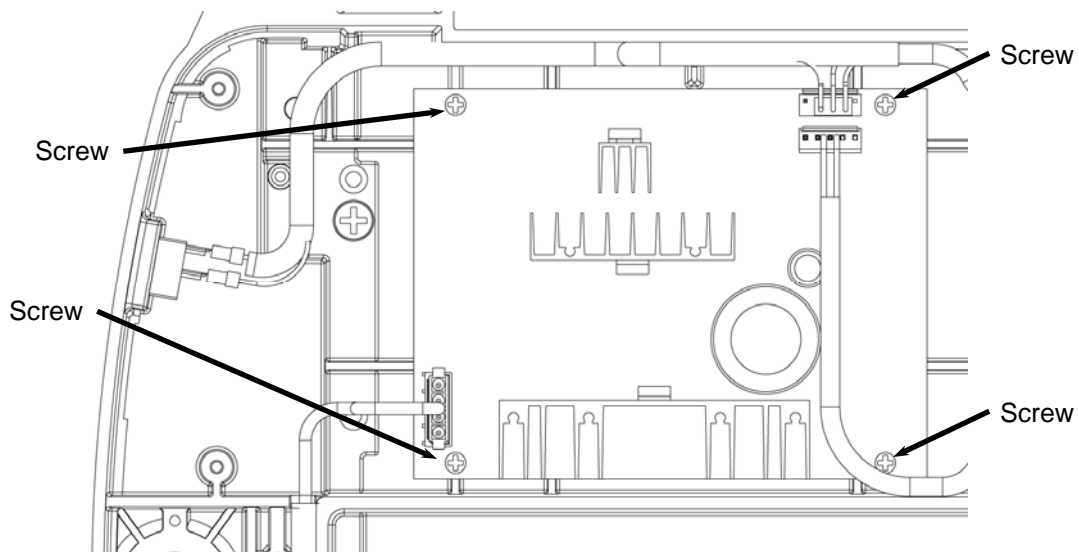

FIGURE 3: POWER SUPPLY ATTACHMENT SCREWS

Reinserting the Power Supply

1. **Insert the new power supply board.** Position the new power supply so that both of the three-pin AC power connectors are positioned along the outside wall of the base. Position the four corner holes in the power supply over the holes in the base casting.
2. **Secure the power supply.** Replace and tighten the four screws that secure the supply to the base casting.
3. **Reconnect the cables to the power supply board.** Connect each of the three cables going to the power supply as shown in Figure 2. Each cable connector has an orientation keying feature that restricts the connector from being plugged in backwards. **DO NOT FORCE A CONNECTOR.** If the connector does not seat easily please check the orientation and try again.
4. **Replace the bottom cover.** Replace the metal cover with the louvers pointing into the machine (see Figure 1). Insert and tighten the 12 screws. The four rubber feet are placed at the corners of the machine.